

Blyth Enterprises - Footmaster Casters - GDN Range - Specifications



GDN-40-F-NYN

- ▶ Load Capacity 50 kg
- ▶ Recommended Load / 4pcs 100 kg
- ▶ Temperature Range -10 ~ 90 °C

● ● Outline

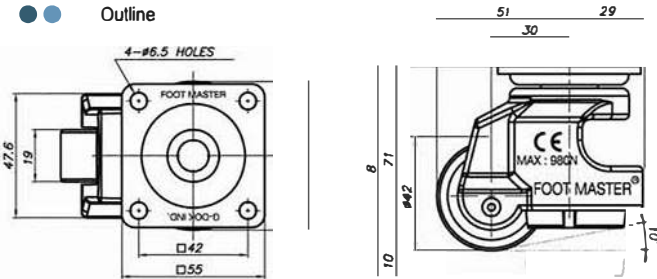

● Materials

Names	Basic materials	Optional materials
Plate	Pressed steel / khaki	
Frame	Aluminum / Ivory	Aluminum / Black
Handle	ABS / Orange	
Pad	NBR / Black	NBR / Gray Antistatic NBR / Black Polyurethane / Natural Antistatic Polyurethane / Natural
Wheel	Nylon 6	
Powder coat & Zinc galvanized		



GDN-40-S-NYN

- ▶ Load Capacity 50 kg
- ▶ Recommended Load / 4pcs 100 kg
- ▶ Temperature Range -10 ~ 90 °C

● ● Outline

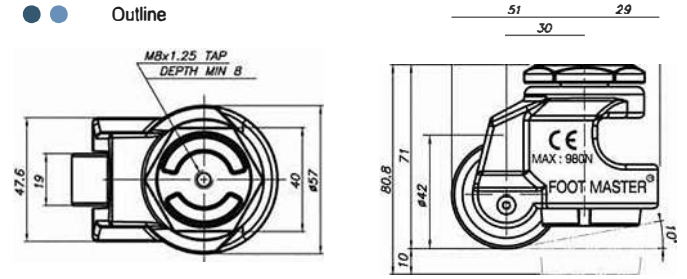

● Materials

Names	Basic materials	Optional materials
Plate	Aluminum / khaki	
Frame	Aluminum / Ivory	Aluminum / Black
Handle	ABS / Orange	
Pad	NBR / Black	NBR / Gray Antistatic NBR / Black Polyurethane / Natural Antistatic Polyurethane / Natural
Wheel	Nylon 6	
Powder coat & Zinc galvanized		



GDN-60-F-NYN

- ▶ Load Capacity 250 kg
- ▶ Recommended Load / 4pcs 500 kg
- ▶ Temperature Range -10 ~ 90 °C

● ● Outline

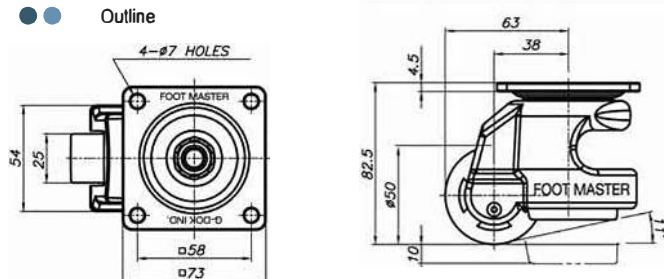

● Materials

Names	Basic materials	Optional materials
Plate	Pressed steel / khaki	
Frame	Aluminum / Ivory	Aluminum / Black
Handle	ABS / Orange	
Pad	NBR / Black	NBR / Gray Antistatic NBR / Black Polyurethane / Natural Antistatic Polyurethane / Natural
Wheel	Nylon 6	Polyurethane
Powder coat & Zinc galvanized		



GDN-60-S-NYN

- ▶ Load Capacity 250 kg
- ▶ Recommended Load / 4pcs 500 kg
- ▶ Temperature Range -10 ~ 90 °C

● ● Outline

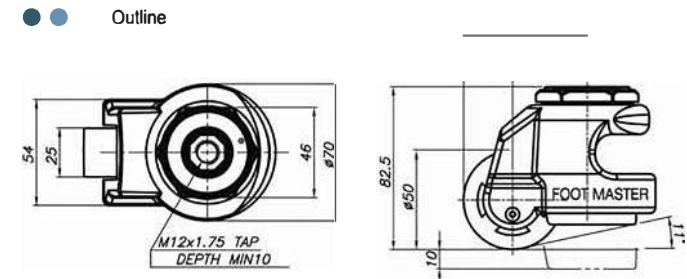

● Materials

Names	Basic materials	Optional materials
Plate	Pressed steel / khaki	
Frame	Aluminum / Ivory	Aluminum / Black
Handle	ABS / Orange	
Pad	NBR / Black	NBR / Gray Antistatic NBR / Black Polyurethane / Natural Antistatic Polyurethane / Natural
Wheel	Nylon 6	Polyurethane
Powder coat & Zinc galvanized		

Blyth Enterprises - Footmaster Casters - GDN Range - Specifications



GDN-80-F-NYN

- ▶ Load Capacity 500 kg
- ▶ Recommended Load / 4pcs 1,000 kg
- ▶ Temperature Range -10 ~ 90°C

● ● ● Outline

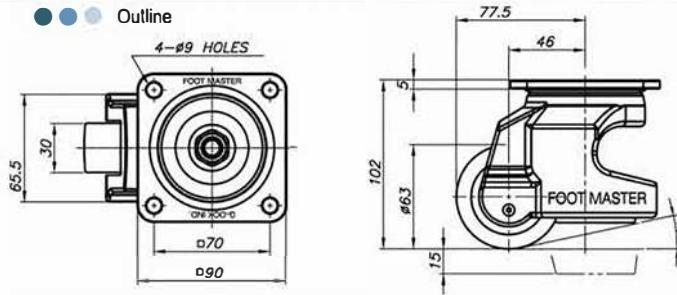

● ● ● Materials

Names	Basic materials	Optional materials
Plate	Pressed steel / khaki	-
Frame	Aluminum / Ivory	Aluminum / Black
Handle	ABS	-
Pad	NBR / Black	NBR / Gray Antistatic NBR / Black Polyurethane / Natural Antistatic Polyurethane / Natural
Wheel	Nylon 6	Polyurethane
Powder coat & Zinc galvanized		



GDN-80-S-NYN

- ▶ Load Capacity 500 kg
- ▶ Recommended Load / 4pcs 1,000 kg
- ▶ Temperature Range -10 ~ 90°C

● ● ● Outline

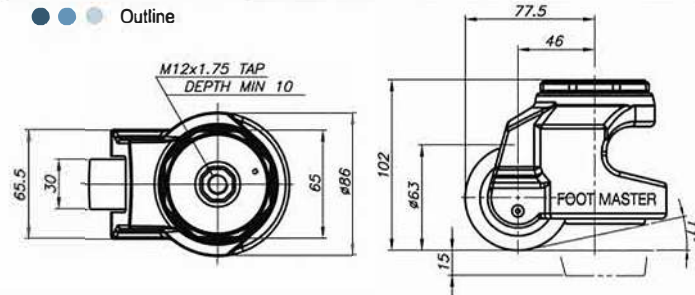

● ● ● Materials

Names	Basic materials	Optional materials
Plate	Pressed steel / khaki	-
Frame	Aluminum / Ivory	Aluminum / Black
Handle	ABS / Orange	-
Pad	NBR / Black	NBR / Gray Antistatic NBR / Black Polyurethane / Natural Antistatic Polyurethane / Natural
Wheel	Nylon 6	Polyurethane
Powder coat & Zinc galvanized		